

Tubular Fencing Installation Guide



PREPARATION

1. Check that both sides of the fence can be easily accessed by removing any objects that may restrict this e.g. tree branches.
2. Call Dial Before You Dig on 1100 to locate any underground services (e.g. gas, water & electricity) that may interrupt the process of installing your fence.
3. Check that your fence meets regulations by getting in contact with your local council.

TOOLS

- Electric or cordless drill (preferably with clutch control)
- 5/16 tek socket
- Shovel
- Crowbar
- String line
- Spirit level
- Tape measure
- Pencil
- Wheel barrow
- Hammer
- 5/6 ring & flat spanner
- Cement

All fittings, brackets, hinges and latches required to secure your posts, panels and gates are included in our panel and gate systems.

FITTING YOUR POSTS

- Mark out each end of the fence line, attach a string (ensuring that it is firm with no sag) and using the panel length, mark the position of your posts on the ground. A general guide for your post holes size is 600mm deep x 200mm wide to give your fence plenty of support. If the area is unstable due to fill, it's recommended that you extend the depth of your hole and length of your post to reach natural ground to avoid sinking.
- It's best to start your installation with your gate, that way you can work around the gate and decide the position and width of where you would like your panels.
- Using a spirit level and the string line to ensure its straight and level, stand your gate post in the hole and concrete the post in, making sure you allow approx. 25mm above the panel and 50mm below. (Note: if installing a pool gate, regulation is that the latch post

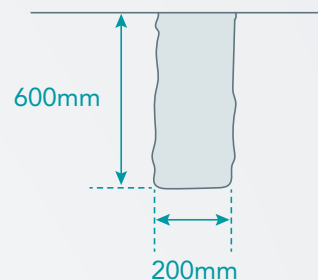

must always be 1500mm from ground level so you will need a longer post)

- Repeat this step again with the second gate post, making sure that your between post measurements matches that of what you have ordered (refer to your paperwork for the between post measurement).
- You are now ready to begin concreting the remaining posts for the rest of the panels. Beginning with the panel closest to the gate, start concreting in your posts one at a time. It's best to allow your posts to set overnight before fittings gate and fence panels.

FITTING YOUR GATES

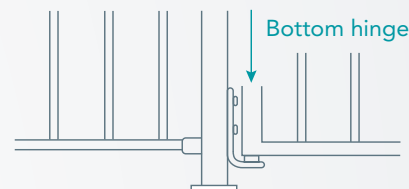
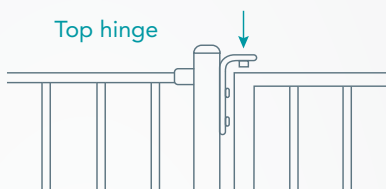

- Firstly decide which way you would like your gate to swing (pool gates are to open away from the pool). Attach a line from one end of the gate post to the other. Set it at the desired height remembering that the string line should be set 50mm above the height of your gate so that you have a 50mm space below your gate (e.g. if your gates and panels are 1200mm high the string line will be set at 1250mm high).

5/16 or 8mm flat spanner, tighten the top hinge to the post.

- You are now ready to screw in the latch and drop bolts to the position you require.

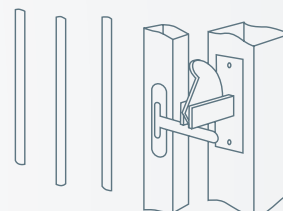

- Position where the gate will be placed and mark where the top and bottom of the gate will sit. Using three tek screws per hinge, attach each hinge to the gate post where marked. Once done you can now unscrew the top hinge and place the gate on the bottom hinge. Sit the top hinge bracket in the top of the gate and using an

- If installing a pool gate your hinges will be self-closing spring hinges. If you decide on the internal spring hinges, place the notched hinge bracket to the top of the gate and tap the spring bush into the top of the gate. The spring tension can then be adjusted to suit your needs.

Tubular Fencing Installation Guide

Innovative
fencing
solutions



FITTING YOUR PANELS

Now for the easy part! Simply slide the rail brackets over the ends of the rails on both ends of each panel. With your first panel in hand, place into position using string line and tek screw both top brackets to the posts. This step is to be repeated until every panel is attached.

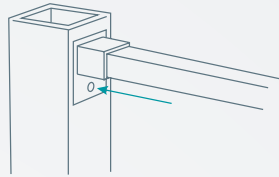

Typical installation of Tubular panel fencing.

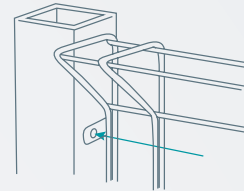

U-Clip attachment as used in standard mesh fencing.

FIXED/ADJUSTABLE HINGE INSTALLATION

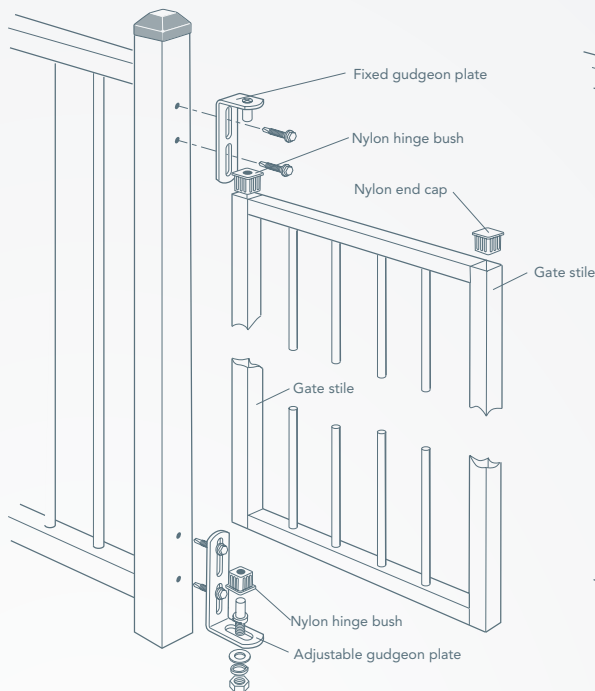

SELF CLOSING HINGE INSTALLATION

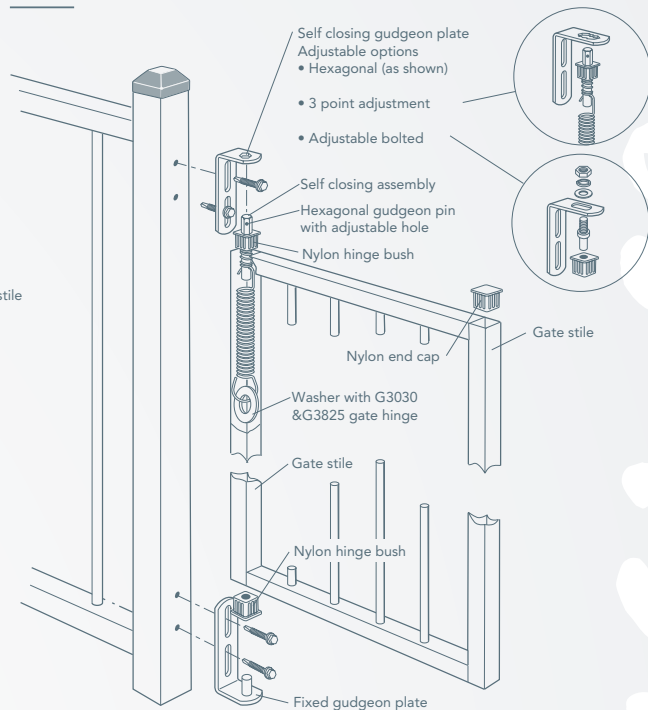

Note: Both the adjustable gudgeon plate and fixed gudgeon plate can be interchanged for top or bottom fixing.

COMPLETING YOUR FENCE

- Using a rubber or nylon mallet, tap the post caps onto the posts gently and wipe down any metal shavings that have been left on the fence.

CARE & MAINTENANCE

Warm soapy water and a soft brush or rag is all that is required to keep your Jackal fence looking its best.

Once clean, a rinse with fresh water to remove any soap will leave your Jackal fence sparkling.

If you live in a normal rural or suburban area this process should take

place every six months.

If located in a coastal or high pollution area it is suggested you perform the above maintenance every 1 - 2 months.

Locks, latches and hinges will benefit from an occasional spray with lubricant.

Think fencing,
think Jackal.

Call us on **03 5444 2472**
or visit jackalfencing.com.au